



## **0.9702 MWp photovoltaic park + Land for another 2 MWp photovoltaic park + BESS**

### **ESSENTIAL INFORMATION**

In 2013, a project for 2.842 MWp was developed on a 77,940 sqm plot located in Timiș County. The Zonal Urban Plan (PUZ) was approved for the entire area. The Grid Connection Approval (ATR) was requested and obtained for 2.842 MWp, to be divided into three phases:

Phase 1 – 0.9702 MWp

Phase 2 – 0.9702 MWp

Phase 3 – 0.9016 MWp

Only the Phase 1 of 0.9702 MWp was built and commissioned in 2013.

The grid connection contract with Enel for the 20 kV overhead power line (LEA) is for 2.842 MW. The connection is currently used only for 0.9702 MW but is built for 2.842 MW.

#### **Production – Green Certificates – Contracts**

Energy produced: 1,156 MWh (2022) – 1,180 MWh (2023) – 1,180 MWh (2025)

There is an electricity sales contract expiring on 31/12/2026 at approximately €60/MWh.

The company receives 3 green certificates per 1 MW produced until 2029.

In 2026, the 3 green certificates per MWh per year are not included in the electricity sales contract. The green certificates expire in 2032. Min/max price in 2024: €30–35.

Maintenance, insurance, and other costs amount to approximately €25,000/year.

#### **TOTAL COMPANY ACQUISITION COST: [info@energystreet.ro](mailto:info@energystreet.ro)**

Included in the price:

0.972 MWp photovoltaic park in operation

Approximately 5 hectares of free land

Grid connection already built for 3 MW

Green Certificates worth approximately € 120,000



## GENERAL INFORMATION

### **Location**

The photovoltaic park is located in Timiș County.

### **Land**

77,940 sqm

Purchase Contract No. 1038 dated 12.06.2012, drawn up by notary Daniela Miculescu.

### **Zonal Urban Plan (PUZ)**

PUZ No. 4793 dated 23.04.2023 for the entire area of 77,940 sqm

Local Council Decision (HCL) No. 44 dated 28.05.2023

### **Building Permit (AC) for the 2.842 MWp photovoltaic park**

AC No. 17 dated 26.06.2013

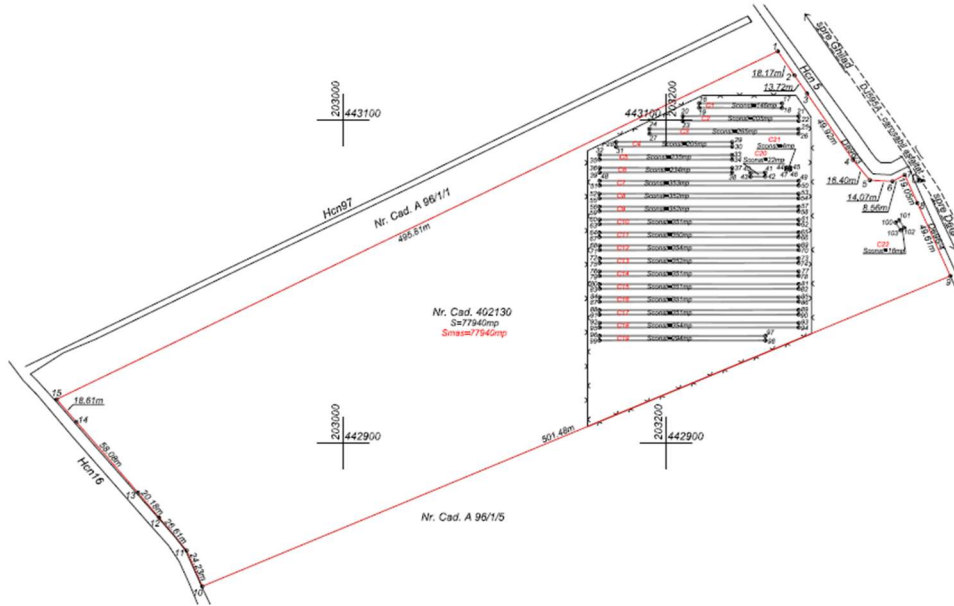
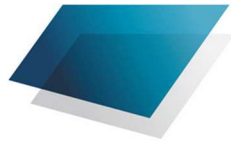

**Building Permit (AC) for the 2.4192 MW Electrical Connection**  
AC No. 306 dated 28/11/2013

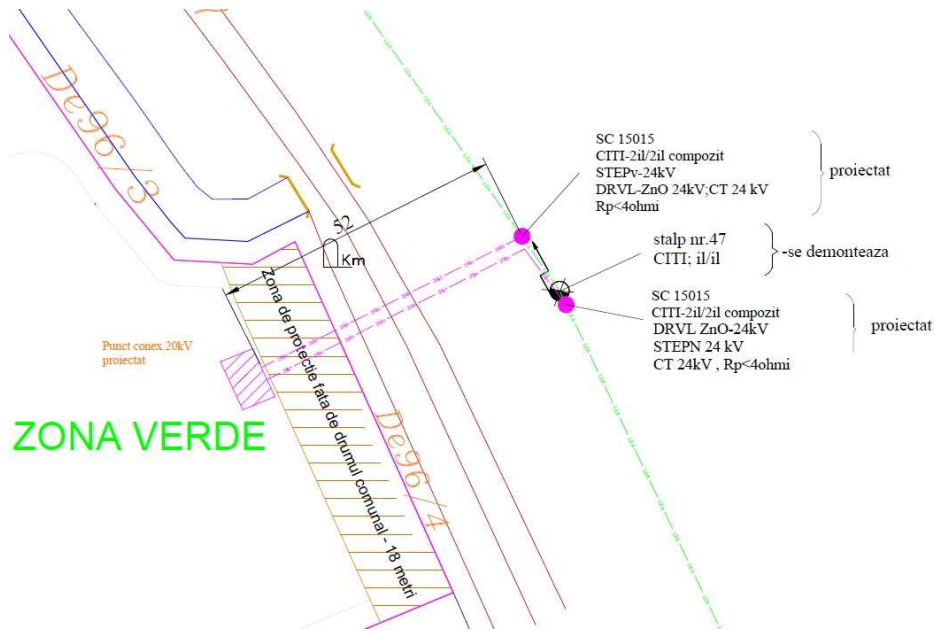

### **Construction of the photovoltaic park - Phase I of 0.9702 MWp**

Construction began at the end of 2013.

The following were installed:

3,960 Znshine 245 Wp photovoltaic panels

9 Socomec Sunsys P100TL inverters (replaced in 2023 with HUAWEI SUN2000 10KTL1)

1 Tesar 1000 KVA Um 24 kV 50 Hz transformer

The land is fenced, has lighting, an anti-intrusion alarm system, video surveillance, a guard house, and an artesian well.



### **Commissioning of the 0.9702 MWp photovoltaic park**

Installed capacity:	0.9702 MWp
Accredited capacity:	0.9702 MWp
Approved capacity:	0.8246 MW
Commissioning Date (official minute):	26.03.2014
ANRE License:	No. 1595 dated 22.01.2014
ANRE Accreditation (3 GC):	No. 770 dated 28.03.2014
Code for participation in the GC Market (PCV):	ROP000000544
Green Certificate Market Participation Agreement:	No. 1595 dated 22.01.2014

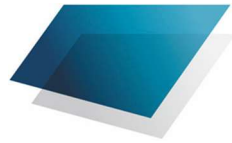

**ENERGY STREET**  
Solutions for Tomorrow

**LAND OF APPROXIMATELY 5 HA FOR THE CONSTRUCTION OF ANOTHER  
PHOTOVOLTAIC PARK + STORAGE SYSTEM (BESS)**

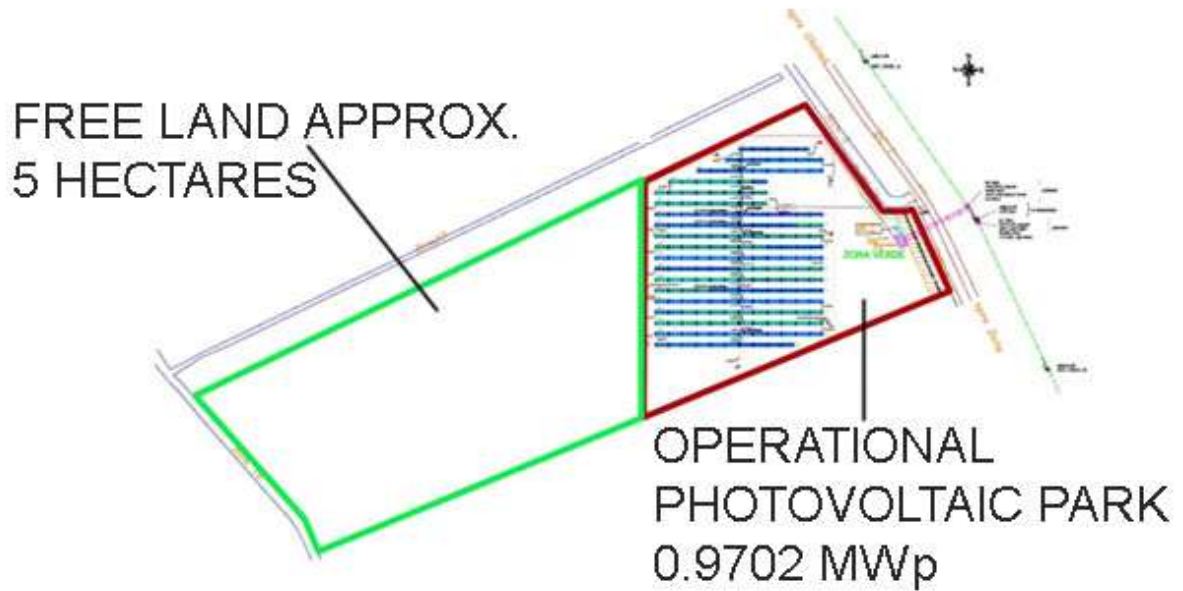

Timisoara, Romania  
Office: +40 723 710190

[www.energystreet.ro](http://www.energystreet.ro) – [info@energystreet.ro](mailto:info@energystreet.ro)